



Cotswold Drive, Stevenage, Hertfordshire, SG1

Guide Price £335,000

Occupying a quiet position within the ever-popular Great Ashby estate, this beautifully finished two-bedroom home delivers spacious, well-considered accommodation in a location prized for its convenience, green spaces, and sense of community.

Offered with no onward chain, the ground floor features a cloakroom, a spacious lounge and a modern, well-appointed kitchen/diner with direct access to the private rear garden. Upstairs, there are two comfortable double bedrooms, including a principal bedroom with built-in mirrored wardrobes and a modern en-suite shower room. The main bathroom is equally well presented, with a full-sized bath and power shower over.

Outside, the rear garden offers a mix of patio and lawn, ideal for low-maintenance enjoyment. To the front, there is private driveway parking, and a single garage measuring approximately 5.93m x 4.27m, significantly larger than average and offering outstanding storage, workshop, or parking space.

This is a rare opportunity to secure a high-quality home in a quiet, well-established part of Great Ashby, within easy reach of excellent schools, parks, shops, and open countryside. Stevenage station is just a short drive away, with fast rail connections into London.

Buyers Information:

In compliance with the UK's Anti Money Laundering (AML) regulations, we are required to confirm the identity of all prospective buyers at the point of an offer being accepted and use a third party, Identity Verification System to do so. There is a nominal charge of £50 including VAT for this service.

- Sold with no onward chain
- Family bathroom & downstairs cloakroom
- Built in wardrobes & ensuite shower to principal bedroom
- Separate lounge & kitchen/diner
- Garage & Driveway Parking
- Good sized rear garden and patio
- EPC rated C
- Double glazing & gas central heating







Score	Energy rating	Current	Potential
92+	A		
81-91	B		87 B
69-80	C	73 C	
55-68	D		
39-54	E		
21-38	F		
1-20	G		

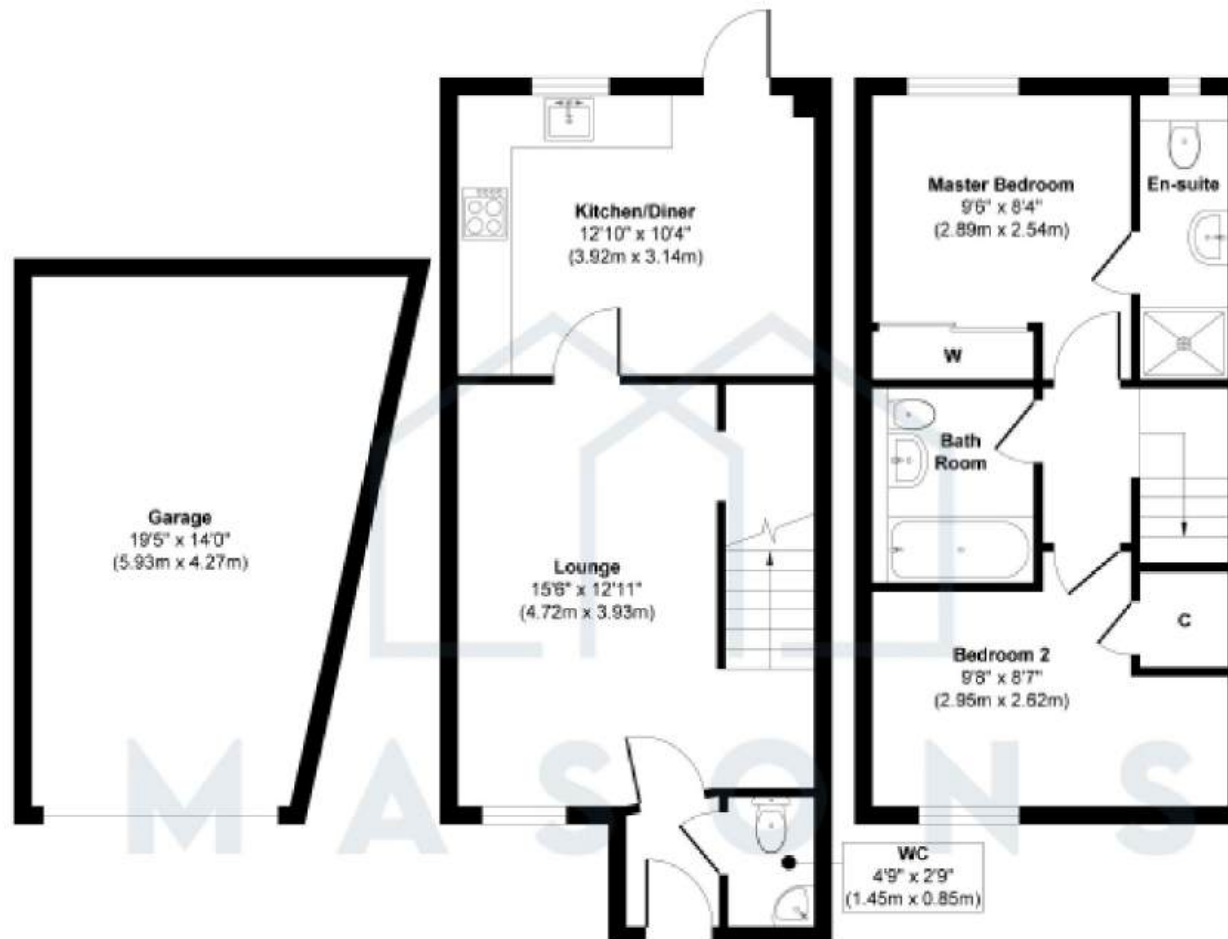

Garage
Approximate Floor Area
229 sq. ft
(21.34 sq. m)

Ground Floor
Approximate Floor Area
377 sq. ft
(35.10 sq. m)

First Floor
Approximate Floor Area
346 sq. ft
(32.19 sq. m)

Approx. Gross Internal Floor Area 952 sq. ft / 88.63 sq. m (Including Garage)

Illustration for identification purposes only. measurements are approximate, not to scale.
Produced by Elements Property